

PROJECT
BASIC
DIFFICULTY



PROJECT TUTORIAL

Victorian House Project

Designed for CarveWright™ by Michael Tyler - www.carvebuddy.com

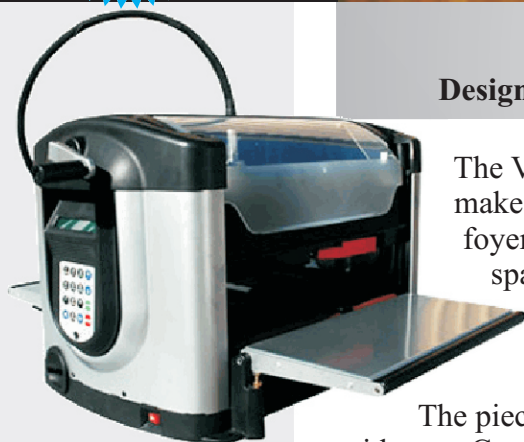

The Victorian House project will make a very nice addition to your foyer, hallway or any other wall space. It also makes a great house-warming gift for a friend or relative!

The pieces are carved and cut out with your CarveWright CNC machine, then layered and assembled using common wood glue.



There are three project files (.mpc files) included, with five separate parts arranged and sized for gluing together - all you need to do is follow these directions for a beautiful project! The text is completely customizable and the freeware TTF font Bridgnorth is included if you want to use the same style text as shown in the sample.

The project uses just the 1/16" Carving Bit and the 1/8" Cutting Bit. No other bits are required.

The finished dimensions are about:
15.5" W x 23.5" T x 2.25" D

Main items you will need:

1) The Project Files (included):

- Hanging_Plaque.mpc
- House-sections_1-2.mpc
- House-sections_3-4.mpc

2) Boards with the following dimensions:

Hanging Plaque: 0.75" x 7" x 24"

Sections 1-2: 0.75" x 11" x 26"

Sections 3-4: 0.75" x 11" x 25"

NOTE: Do not use boards that are smaller than specified above unless using an appropriate jig. Larger boards are fine.

3) Bridgnorth freeware font (included)

4) Sandpaper, wood glue, wood stain and/or paint and clear finish

5) A Dremel-type rotary tool with assorted sanding wheels and bits to sand small details and speed up preparation for finishing.



Victorian House Project

(cont.)

STEP 1

Start your Designer software and open the .mpc files. (fig. 1a)

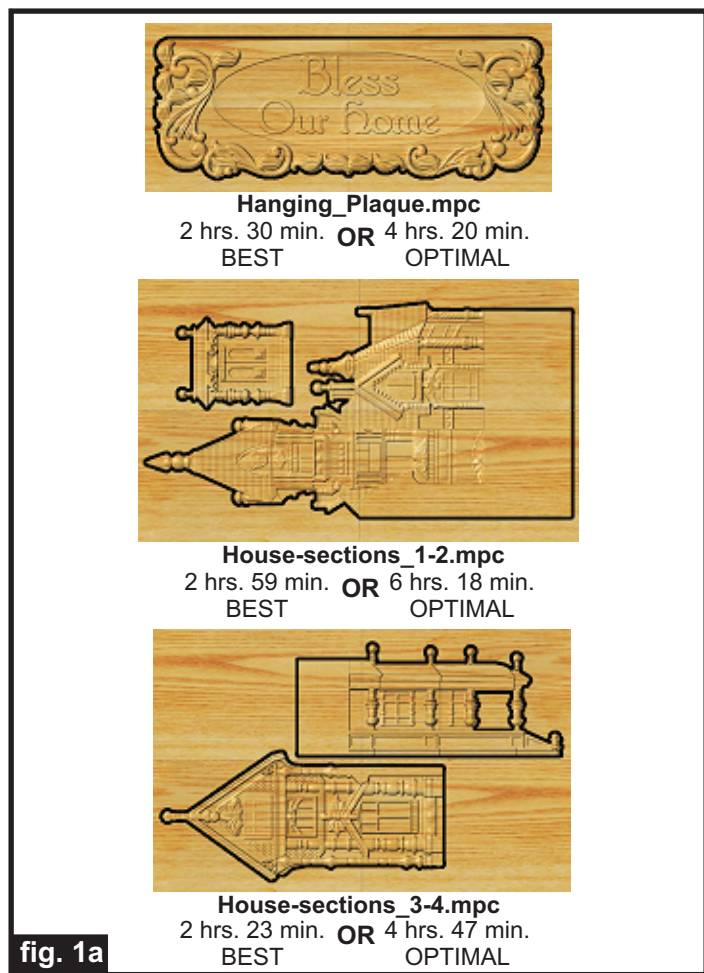

fig. 1a

Upload the project file(s) to your memory card. (File/Upload). During upload, you may or may not see a pop-up window with an "Auto-Jig" warning message. (fig. 1b)

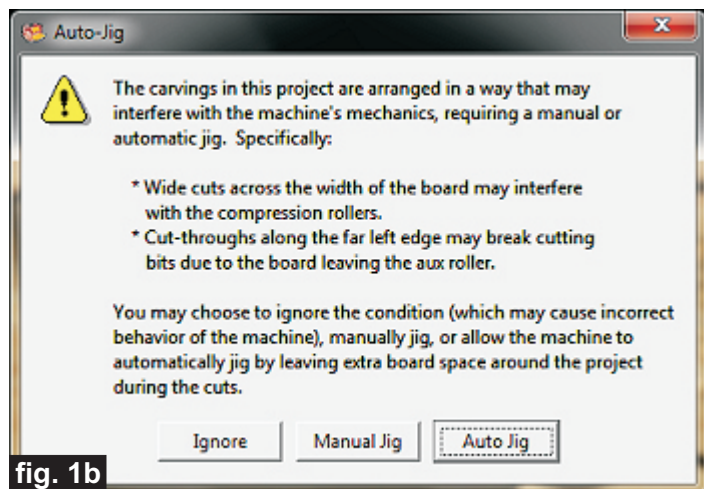

fig. 1b

If you do see the message(s), you may safely click on "Ignore" because each board will be large enough that it won't cause any problems at all. After each project is compiled, select "Best" or "Optimal" for the File Quality setting. (I used "Best".)

Click "OK" and upload each mpc project file to your memory card. Insert the card into your machine and load a board that measures the appropriate dimension specified for each particular mpc (see page 1 for board dimensions). Turn on your machine and proceed with the standard project setup in Step 2...

STEP 2 - Running the MPC File(s)

You will see "Project Menu" on your LCD display. Press "1" and scroll to **Hanging_Plaque.mpc** project, and press the green ENTER button to select it. Then follow the additional prompts....

- **Stay Under Rollers** - press 1) YES
- **DO NOT RESIZE or SCALE the projects!** If prompted, always keep the original size. No scaling!
- **How To Place** - press 1) Center
- **Cut Board to Size?** - press 2) NO
- **Select Cutting Bit: 1/8 " Cutting** - Press ENTER. The machine will move the bit holder to the center of the machine in preparation for the bit installation.
- **Load Bit: 1/8 " Cutting** - Insert your 1/8 " cutting bit, then press the green ENTER button. (homes, etc.)
- **Select Carving Bit: 1/16 " Carving** - Press the green ENTER button. (Moves to center of machine.)
- **Load Bit: 1/16 " Carving** - Remove the 1/8 " cutting bit, and insert your 1/16 " carving bit, then press the green ENTER button. After homing and finding surface, the machine will begin the carving process.
- **After it is done carving, you will be prompted to load your 1/8 " cutting bit.** Remove the 1/16 " carving bit, insert your 1/8 " cutting bit, then press the green ENTER button. The machine will now proceed to perform the cutouts. Remove the board when done. Repeat the same procedures as outlined above for the remaining **House-sections_1-2.mpc** and **House-sections_3-4.mpc**

(cont.)

Victorian House Project

(cont.)

STEP 2 - Running the MPC File(s) (cont.)

Your boards will look something like this...(fig. 2)

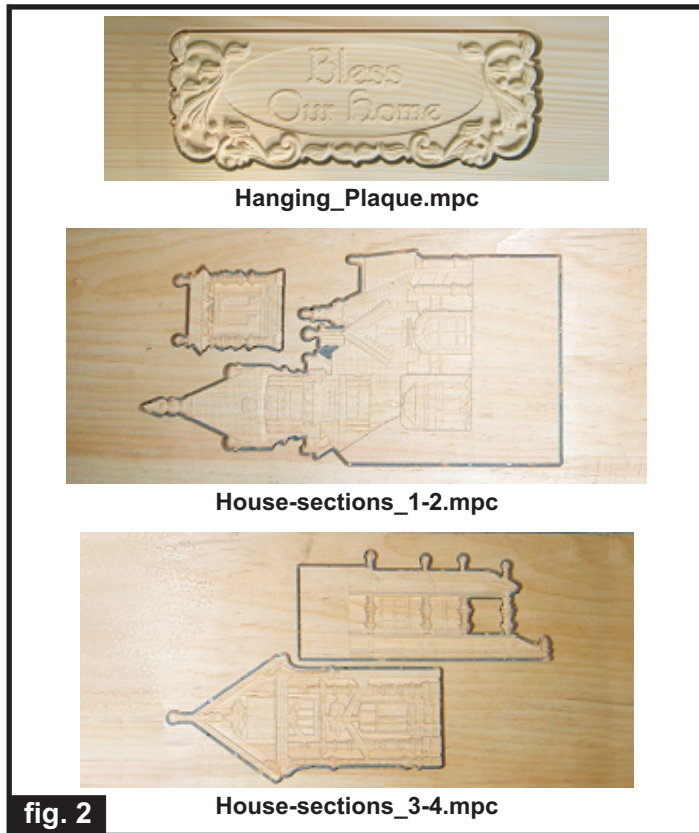

STEP 3 - Separate Parts from Material

Separate the parts from the boards. Sand off tabs and undesirable toolmarks. (fig. 3a, 3b, 3c)

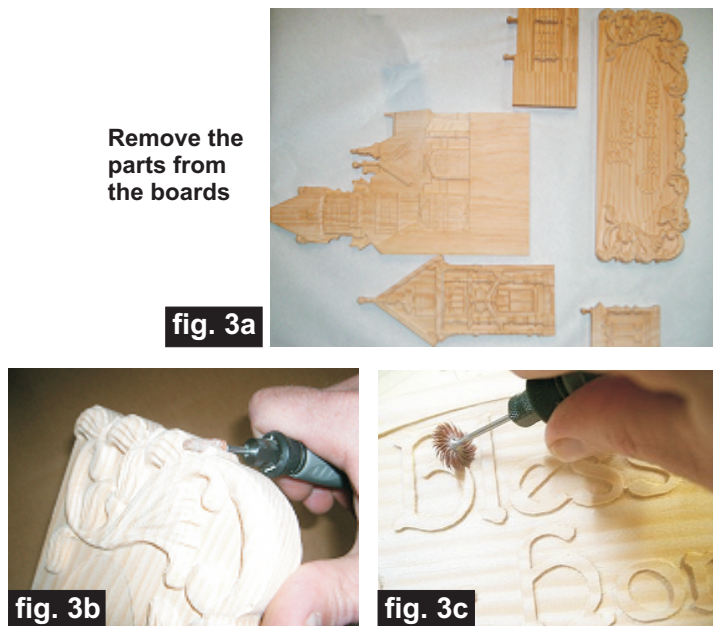

Sand off tabs, fuzzies and undesirable toolmarks

STEP 4 - Assembly

Dry-fit the house together to get the idea how they are layered and connected before gluing. (fig. 4a)



Glue the house together. Use a pin nailer or CA glue to tack in inconspicuous areas. Allow to dry. (fig. 4b)

Glue the sections together and allow to dry.



The hanging plaque portion can either be glued directly to the house assembly (that's what I did), or you can install screw eyes and hooks to hang the plaque portion from the bottom of the house. (fig. 4c)



You can opt to glue the plaque to the bottom of the house assembly like I did for the sample. I used scrap wood underneath the plaque to elevate it when glued at the "side porch" level.

(cont.)

STEP 5 - Apply Finish

Apply your choice of finish. You can paint the house with acrylic craft paints, or stain it, or leave it natural with only a clearcoat overall. Here's what I used on my Victorian House sample made from Select Pine...

(fig. 5):

- One coat thinned Bulls Eye SealCoat. (50/50 sealer and denatured alcohol)
- Sanded again
- Applied Rust-Oleum Golden Mahogany stain
- Applied several light coats of Krylon Clear spray
- Applied metallic gold paint pen on text areas



fig. 5

IN CONCLUSION

Add a picture hanger on the back to hang on the wall. I hope you enjoyed making your Victorian House!

Happy Carving!

Michael

Michael Tyler



(cont.)

Materials Source Page

- **3M Radial Bristle Discs** from www.mcmaster.com
(stack 3 discs at a time on your rotary tool mandrel)
 - 80-grit:** part # 4494A19
 - 220-grit:** part # 4494A18



Items Purchased at Home Depot™ or Lowes™

- Zinsser Bulls Eye SealCoat and Denatured Alcohol
- Rust-Oleum Ultimate Stain - Golden Mahogany
- Krylon Clear Spray
- Sawtooth Picture Hangers
- Optional: Screw Eyes and Hooks
- Disposable Brushes and Paint Rags



Items Purchased at Hobby Lobby™ or Michael's Arts & Crafts™

- Metallic Gold Paint Pen



Krylon Crystal Clear Spray
from Lowes

NOTE: Direct weblinks and prices were valid at time of this writing, but can change at any time. If links don't work, then try visiting the website's home page and do a Search for the item to get directed to a current/valid page.

Additional Resources

RESOURCES...

There are numerous resources for the CarveWright/CompuCarve owner to make their experience with these machines much more enjoyable.

Every owner should join the CarveWright User Forum (<http://forum.carviewright.com/forum.php>) where fellow users share their experiences and knowledge with these machines on a daily basis. It is a FREE service that you will surely appreciate. A handy Search Feature helps you find answers to any questions you may have.

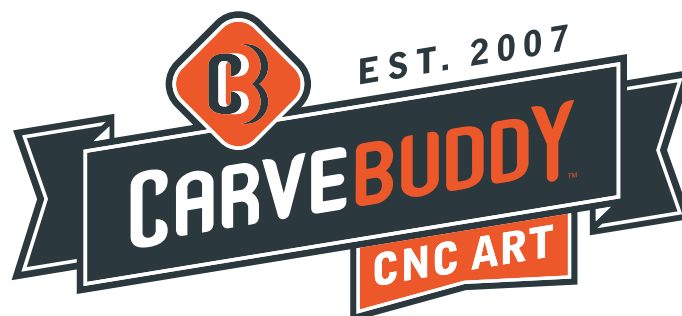

www.carvebuddy.com

The trademarks, service marks and logos (the "Trademarks") used and displayed here are registered and unregistered Trademarks of LHR and others.